

2025

# MIDWEST

600 MODIFIED  
RULE BOOK

# **Track Inspection & Rules**

- **All cars are required to have a safety inspection by Midwest 600 Modified Representatives prior to coming to the track the first night of racing or before pits open the night of the first race (specifically for safety reasons)**
- **Interpretation of rules will be at the discretion of the designated technical inspector.**
- **All decision by Midwest 600 Modified officials will be final.**
- **Rules not covered such as new technology or physical advantages are not allowed without prior consent. If the rules do not explicitly state that you can do something, and it creates an advantage, it is assumed that is prohibited.**
- **Officials have the right to check anything on any car at any time.**
- **Officials have the right to amend any rule at any time for the betterment of the series.**
- **The first 4 finishers in the main event, and any other racecars as instructed by officials, are required to report to a designated area after the completion of the main event where post-race technical inspections will be performed.**

# **Tires: American Racer**

- **Stock Tires**
- **Must be on all 4 corners**
- **Right Rear 61x10x10**
- **Left Rear & Fronts 57x6.5x10**
- **Grinding tires is allowed**
- **NO SIPING TIRES**
- **NO REGROOVING TIRES**
- **NO CHEMICALLY TREATING ANY TIRES**
- **Left Rear Offset: outside of Left Rear tire to frame by lower inner rub rail**
- **18' max for Old Style Cars**
- **17" max for New Style Cars**
- **Durometer reading must meet specifications determined by Midwest 600**

**Modified Officials**

# **Rims**

- **Front and left rear 7 1/2" wide maximum**
- **Front 3" offset only**
- **Right Rear 8 1/2" wide maximum**
- **NO DOUBLE BEADLOCKS**
- **NO ALUMINUM OR TITANIUM BOLTS IN BEADLOCK RINGS OR HUBS**
- **All bolts must be in wheels**
  - **8 bolts and nuts**
- **NO PLASTIC OR CARBON FIBER WHEELS**
- **NO BLEEDERS OF ANY STYLE**
- **Left Rear Offset: outside of Left Rear Tire to frame by lower inner rub rail**
  - **18" max for Old Style Cars**
  - **17" max for New Style Cars**

# **Hubs**

- **Aluminum only**

# **Steering**

- **Must be rack and pinion steering from Xcel Chassis**
- **NO ALUMINUM STEERING SHAFTS**
- **NO ALUMINUM U-JOINTS**

# **Spindles**

- **Steel snout, 4 bolts to hold steering arm on Xcel spindles or new Xcel spindles and arms**



## **Fuel Cell**

- **Vent Line must be secured to side and pointing down to track**
- **Fuel vent line requires one-way check valve**

## **Weight**

- **Minimum weight with the driver is 900 pounds at completion of race**
- **Weights must be bolted with 5/16 bolts and lock nuts**
- **Weights must be painted white and have care number painted on each one used**
- **All bolt on weight must be inside the main body**
  - **CANNOT BE MOUNTED TO THE BODY PANELS**

## **Radiator**

- **Stock from motorcycle only**
- **AFCO OR EQUIVALENT**

## **Gear**

- **Open, 520 chain**
- **Front gear and chain must be steel**

## **Gear Linkage**

- **Driver must be in racing gear by turn 3 for all starts and restarts**
- **NO SHIFTING DURING THE RACE**
- **Must have shift light**
- **If light comes on and you advance a position you will be penalized two positions at next caution or end of race**
- **Light must be big enough to be seen from tower**

## **Rear Brakes**

- **2 piston caliper only**
  - **Wilwood #3120-4062**
  - **AFCO #6630410**
- **One rear brake**
- **10" maximum diameter brake**
  - **Disc with 4 bolt mounting hub**
- **5/16" thick maximum**
- **3/4" master cylinder**
  - **Wilwood #2606764**
  - **US Brake #201-2512**

## **Front Brakes (FRONT BRAKES ARE OPTIONAL)**

- **Front Brakes are Optional**
  - **IF YOU RUN FRONT BRAKES, YOU MUST RUN BOTH DISKS AND CALIPERS ON BOTH THE LEFT FRONT AND RIGHT FRONT**
  - **BOTH FRONT BRAKES MUST WORK**
- **1/8" thick rotor**
- **Brake line master cylinder**
- **NO PROPORTIONING VALVES**
- **T, 24" line to front axle**
- **T, 24" line to right side**
- **16" line to left side**

## Belly Pan

- Front must stop at steering box
- Back must stop at bar with serial number on it
- Belly pan must be on top of frame rails
- NO BELLY PAN OUTSIDE MAIN FRAME RAILS

## Gauges

- Tach is only gauge that can be connected to wire harness
- 3 gauges in car: oil pressure, water temperature, tachometer
- No more than 3 on/off switches in car
  - 1st switch- on/off for engine
  - 2nd switch- fan, helmet blower or light enabling sight to get in and fasten seatbelts.
  - 3rd switch for helmet blower or be labeled

## Birdcages

- Right Rear and Left Rear double or single bearing bird cages

## Transponder

- All cars must have a transponder and it needs to be mounted inside the panel on the side of car that faces the outside of the race track. See diagram to the right.

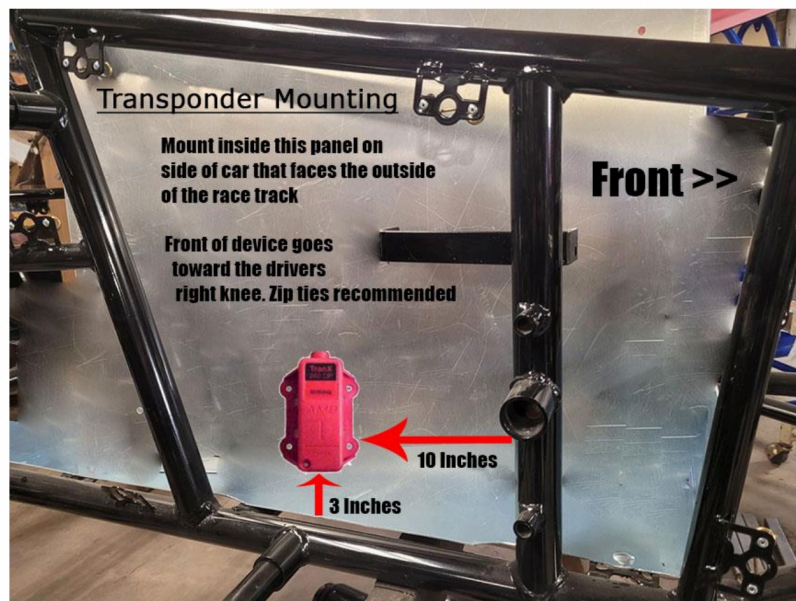

Transponder Mounting Location Diagram

# Engine

- **ALL ENGINES MUST HAVE A CURRENT 2025 SEAL**
  - **ENGINES MUST BE SEALED BY ONE OF THE FOLLOWING: MENSINK RACING SUPPLY, MUMMS THE WORD RACING, OR ROSBURG REPAIR**
- If a seal is tampered with in any way shape or form you are disqualified
- Stock from motorcycle, including injections, clutch and black box.
- Spark Plugs:
  - Suzuki: NGK CR9E
- All rebuilds are done by Xcel Chassis dealer, Mumms the Word Racing or Rosburg Repair
- NO POWER COMMANDERS
- NO AFTERMARKET DEVICES
- Suzuki GSXR 600 only 2000-2010
- Suzuki 2011-2020, **MUST RUN 2006-2010 ELECTRONICS**
- Suzuki-Kinzler adj. high speed bypass
- NO PILL BLOCK
- 12-volt battery only
- All wiring harnesses must be removable
- Tach wire must be accessible to officials at all times
- **Engines must have a current 2025 seal from one of the following: Mensink Racing Supply, Mumms the Word Racing or Rosburg Repair**

## Engine Protest Policies

- Included in protest are the following: engine, wiring harness, black box and everything but header and air box.
- All engine protests are mandated to be pulled at the track the night the protest is made.
- Protested engine will be taken to \*\*\* shop that night and will be re-teched. If a protest is on a two-day race event, the protested engine will be marked by track official the first day and will be confiscated at the end of the second day.
- All protests must be in writing and given to tech official, Jay Mensink or Midwest Modified 600 Representatives along with the \$500 protest fee
- Only owners can file an engine protest
- An owner can protest one engine a night
- To protest an engine, owner's car must have finished 7th or better in that night's feature
- The engine protested must have finished 7th or better in that night's feature.
- \*\*\* shop receives \$100 of the protest money no matter the outcome.
- If found legal: owner of the protested engine will receive \$400 and return of the engine.
- If found illegal: protester will receive \$400, and \*\*\* shop keeps engine, owner of engine receives monetary fine and suspension determined by \*\*\*\* (Midwest Modified 600 Representatives)



## Wheelbase

- **66 1/4" minimum to 67 3/4" maximum**

## Muffler/Exhaust

- **Beyea or Schoenfeld's**
- **NO JET COATED HEADERS**
- **NO CERAMIC HEADERS**
- **NO STAINLESS HEADERS**

## Radius Rod

- **RF 11"**
- **LF 10 1/2"**
- **RR 14 3/4"**
- **LR 13 3/4"**
- **Front pan hard bar 18 1/4"**
- **Back pan hard bar 21 1/2"**
- **Back pan hard bar 23-new style**
- **NO SPRING RODS**
- **NO BUMP RUBBER RODS**
- **New left side pan hard bar is 25"**

## Wheel Width

- **63" Maximum**

Wheel Width Diagram



## Bumpers & Nerfs

- **Must be steel and stock from Xcel Chassis/Xcel Dealer**
  - **.065 minimum**
  - **.095 maximum**
- **If front or rear bumper comes off during the race, car is finished for the race**

## Battery.

- **Any battery**
  - **Gel, Lithium, 5x7 lawn mower**

## Front Axle

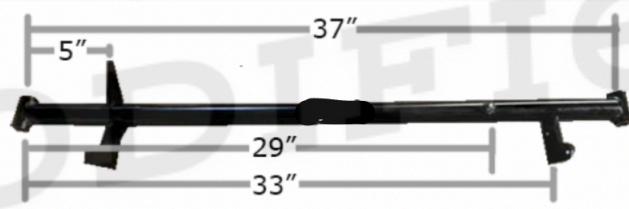

- **One piece steel axle**
  - **Xcel Chassis**
  - **or**
  - **Can make own axle as long as it follows the above diagram specifications**

## Fuel

- **Fuel must be same ambient temp as outside temp**
- **Pump gas only---93 octane maximum**
- **Up to 15% ethanol**
- **NO METANOL**
- **NO ADDITIVES**

# Fuel Pump

- Fuel pressure 43 to 51 for Suzuki
- Mallory #4060FI
- Holly Red
- Holly 12-882
- Walbro
- Blue High-Pressure Fuel Line Only
- Must run a #640863 Russell fitting on the fuel rail

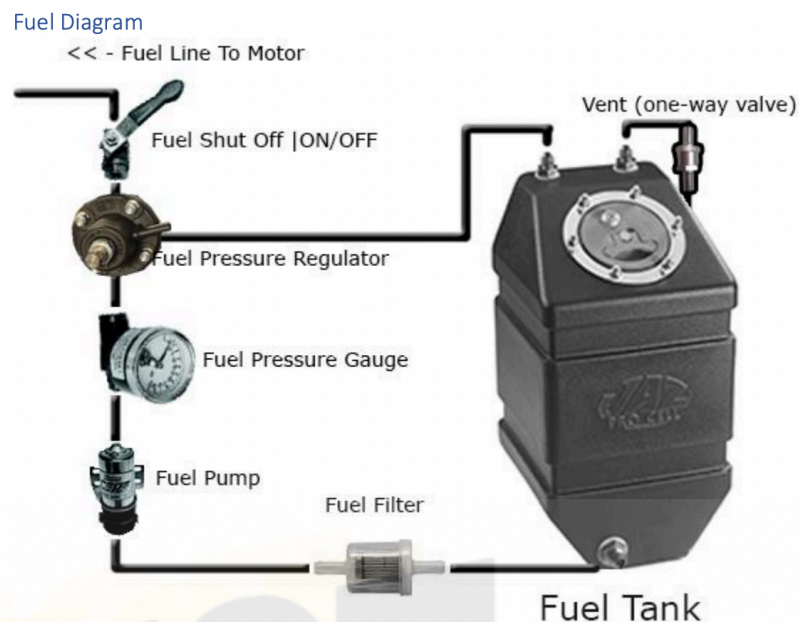
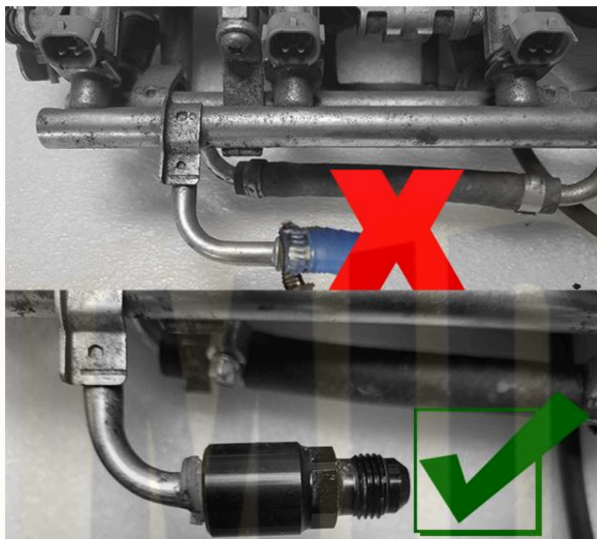

# Shocks

- Stock shock
- Bilstein Xcel #1 or Penske Xcel #2
- Only one manufacturer of shock on all corners of the car. NO MIXING BETWEEN BILSTEIN & PENSKE
- NO CUTTING SHOCKS APART OR CHANGING VALVES
- NO SPRING SHIMS OR SPACERS
- Shock extension is 1 inch only-black only (4-inch threaded tube coil kit)
- NO BUMPER RUBBERS
- NO DRILLING AND/OR LETTING GAS OUT OF SHOCK

# Springs

- Open
- Only one spring per shock
- Only 4 springs per car
- 1 7/8" diameter spring only
- NO BARREL SPRINGS

# Numbers & Letters

- Must reserve car number with registration
- Must be displayed on the roof, both sides of car and on back
- Size must be 16 inches in height for top and sides
- Letter in front, back or in number must be 8 inches minimum for top and both sides

## Body

- Rear deck must measure between 18 1/4 to 18 3/4 top of bumper to deck
- 6- 2 1/2" holes LF bottom door (air for engine)
- Hole in hood for air 1 1/4" by 6 1/4" maximum
- Optional louvers for air box- 2 rows of 10 - 3" louvers
- No skirting below the frame in front or on both sides
- All body parts must be on the car at the start of each race
- Firewall must be in car at engine
- Must fit Xcel template

## Frame

- **Xcel Chassis Only**
- All changes to the frame must be in letter form explaining reasons for changes. After approval, Xcel will stamp letter and must be available for representation to Xcel Chassis officials at any time.
- Must remain stock from Xcel Chassis NO CUTTING BARS
- NO ADDING BARS
- NO MOVING BARS TO DIFFERENT SPOTS
- Engine must remain in stock position from Xcel Chassis
- All cars must have rock screen on front for driver's safety
- Must have cage around fuel tank

## 2011 or Newer & Cars with 2011 Updates

- Battery is in back of car
- Updates can be done by Xcel Chassis only
- Aluminum engine plates must be from Xcel Chassis



# **Air Box**

- **Stock from Xcel Chassis**
- **Stock boots cut down**
- **Air box cover must be on the car and must have fire shield covering the engine blanket**
- **NO AIR INDUCTION SYSTEM AND/OR RAM AIR**
- **Air filter must be:**
  - **Green-2004**
  - **K&N- #33/2084**
  - **K&N- #33/2018**
  - **Twin Air- #Xcel Chassis**
- **If you run only twin air, you can run steel mesh in air box to help hold up the air filter**

# **Rookies**

- **Status: if you are new to series and did not race a car bigger than a 600 modified, you are deemed a rookie**
- **All rookies must have “Rookie” displayed on back deck**
- **All rookies must start at the tail end of a heat race for a minimum of 4 events**
- **After 4 race events Midwest 600 Modified Representatives will determine eligibility for pill pull**

# **Driver on Track Behavior Expectations**

- **NO SHIFTING STARTS OR RESTARTS**
- **Driver must be in racing gear by turn #3**
- **If you unbolt and get out of the car on the track you are finished for that race (unless instructed to do so by an official)**
- **NO JACK RABBIT STYLE STARTS**
- **All race procedures will follow each track’s procedures**
- **It is the driver’s responsibility to understand each track’s race procedures**



# **Pit & Track Behaviors**

- An owner is responsible for the conduct of the crew and driver at the track
- All owners, drivers, crew and team members must act like ladies and gentlemen at all race events.
- Any individual and/or individuals who may get into a fight or unseemly argument at the track shall immediately be suspended from the days or night events. Xcel Chassis officials may impose a monetary fine and/or a 2 to 4 race suspension for each individual.
- Any and all actions, including the internet, by an individual and/or individuals ruled detrimental to the following:
  - Series officials, drivers and owners will receive a \$75 fine or higher, along with a possible suspension and/or lifetime ban.
  - Only owners and drivers may approach an official at any time, in trailer to discuss race event and procedures.

## **Miscellaneous**

- \*\*\*Receiver Radios are mandatory and must be working during race events\*\*\*
- Head and neck restraints are mandatory and must be SFI rated minimum of 38.1
- Any and all suspensions include weekly tracks on race days. If race is cancelled or track is not open, this is not included.
- Driver cannot have any electrical devices (ex: cell phone, credit card with chip) on person or car during any race events, race receivers are allowed. Transponders are mandatory.
- 1 in car camera is allowed in car but cannot face any suspension.
- NO MAGNESIUM
- NO TITANIUM
- NO TRACTION CONTROL
- NO AIR SHIFTER
- NO DATA ACQUISITION SYSTEMS
- NO COCKPIT ADJUSTABLE DEVICES
- NO CARBON FIBER
- NO DRILLING OR HOLLOWING OF ANY BOLTS AT ANY TIME
- NO RADIO COMMUNICATION IN CAR
- Total 3 air ducts--1 must be for brakes
- NO ALUMINUM BOLTS
- Rental car or any outside driver that is not a regular driver with the 600 series will start in the back of the heat race and will start no better than 10th position in the night's feature race.
- Only owners and drivers may approach an official at any time, in trailer to discuss race event and procedures.
- All cars must have safety bars updated
- Full containment seats

